

ADD. TO ELIZABETHTOWN

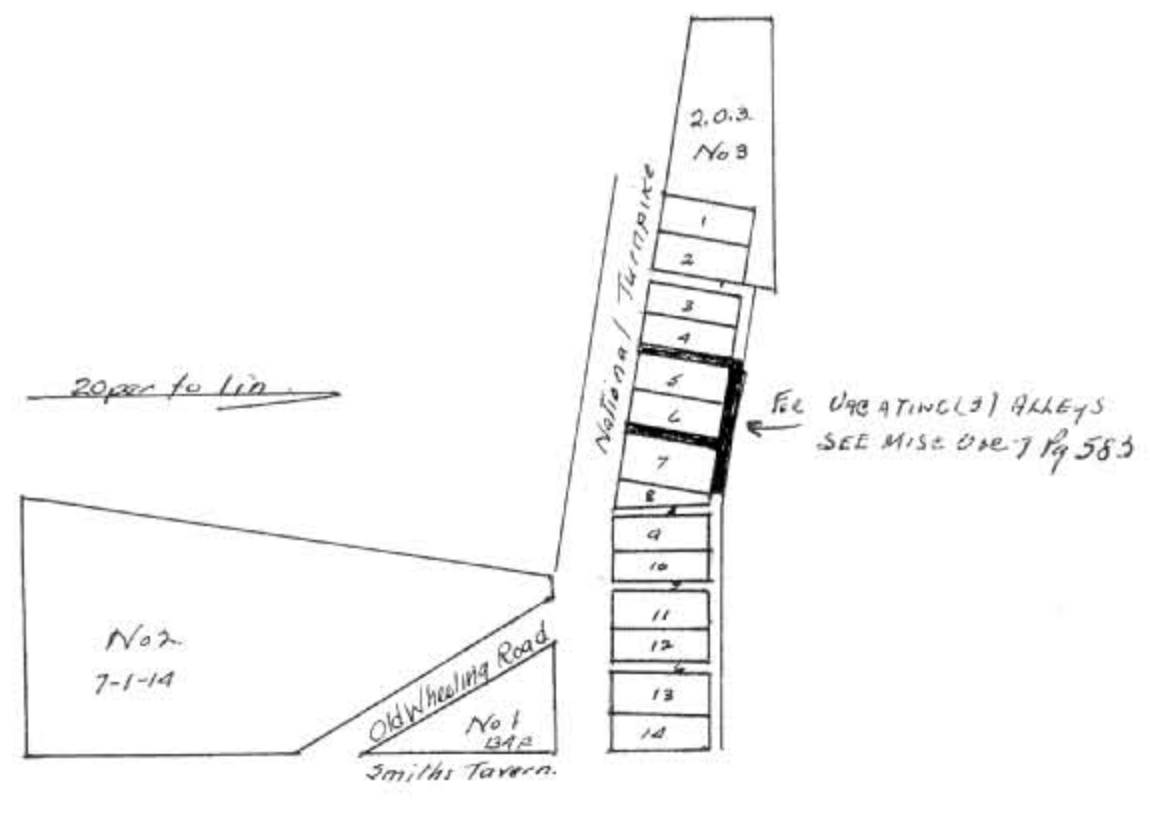

Restoration of Public Records

laid out on the National Turnpike on the 7th of Mar. 1832. Proprietor Jacob Weller. beginning at a stone north of said Pike & west of Blaensmiths shop. Said shop stands in SE cor. of 1/2 lot No 2. bearing on part of pike $579^{\circ}E$. 132 ft & 165 ft back at right angles including 1 1/2 lots. The back part of 1/2 of lot No 2 reserved thence commencing East of said shop on 1/2 lot bearing on part of said pike $580^{\circ}1/4^{\circ}E$ each lot in succession. 66 ft in front & 165 ft back. each alley 16 1/2 ft wide whole number of lots laid off is 7. No. of alleys. 3. National Road 4.8 rods wide back alley. 20 ft wide The above laid out south of turnpike commencing at a stone between said Prop. & Smith. thence S. 22.04 per thence N $28^{\circ}3/4^{\circ}W$. 25 per. & 12 hundredths. Thence east 12.16 per to beginning contains 134 per. lot No 2 beginning at a stone west of the old Wheeling road & adjacent the pike thence S. $27^{\circ}1/2^{\circ}E$. 34.6 per. South 27.8 per. thence west 28 per. thence North $8^{\circ}3/4^{\circ}E$. 59 per. thence East 2.80 per. to beginning contains 7 acres. 1 rood & 14 per. Old wheeling road 66 ft wide bounding on the pike thereby certify the above plat & notes to be correct as they stand stated Given under my hand this 12th day of Mar. A.D. 1832. O. Brashear Sur. Add to Elizabethtown laid out by Jacob Weller. on the National turnpike on the N.E. quar. of Sec. 14. Twp 2 & R1. beginning for said addition at the east side of lot No 7. bearing in fractional lot No 8 $580^{\circ}3/4^{\circ}E$. 59.4 ft. thence N 166.3 ft. N $80^{\circ}3/4^{\circ}W$ 19 1/2 ft. S $9^{\circ}1/4^{\circ}W$ 165 ft. contains 27.3 per. thence commencing east of the first alley in the addition marked No 4. & east of said lot No 8 thence bearing in front parallel with pike due east in progression to lot No 14. such lots excepting lot No 8 are 66 ft in front at right angles. due north 165 ft back. contain 1/4 acre also a large lot laid off on the west end of town. No 3 commencing at the S.E. cor of 1/2 lot No 2. N $80^{\circ}W$ 8 per. N $79^{\circ}W$ 19.6 per. North 8.10 per. thence south 29.68 per. S $10^{\circ}W$ 13.84 per. to the beginning. contains 2 acres & 3 per. including lot No 1 & half of lot 2. as seen on the above plat The Plat of the addition to said town. is connect & adjoining the original plat as above each alley. between every other lot 16 1/2 ft wide the back alley. 20 ft. Turnpike 90 ft thereby certify the above to be correct as they stand stated Given under my hand this 20th of Oct. 1833. State of Ohio Que Cb 55 O. Brashear SGC. O

Before me a Justice of the Peace in & for said county of Gas. came the within named Jacob Weller who acknowledged the within instrument of writing purporting to be a plat of an addition to Elizabethtown in said county. to be his act, & deed. for the purposes expressed Given under my hand & seal this 4th of Nov. 1833.

John Herst Jr J.P.

Received for Record Nov 4, 1833
Recorded